

SPEED QUEEN® MULTI-HOUSING LAUNDRY SOLUTIONS

Commercial Front Load Washers

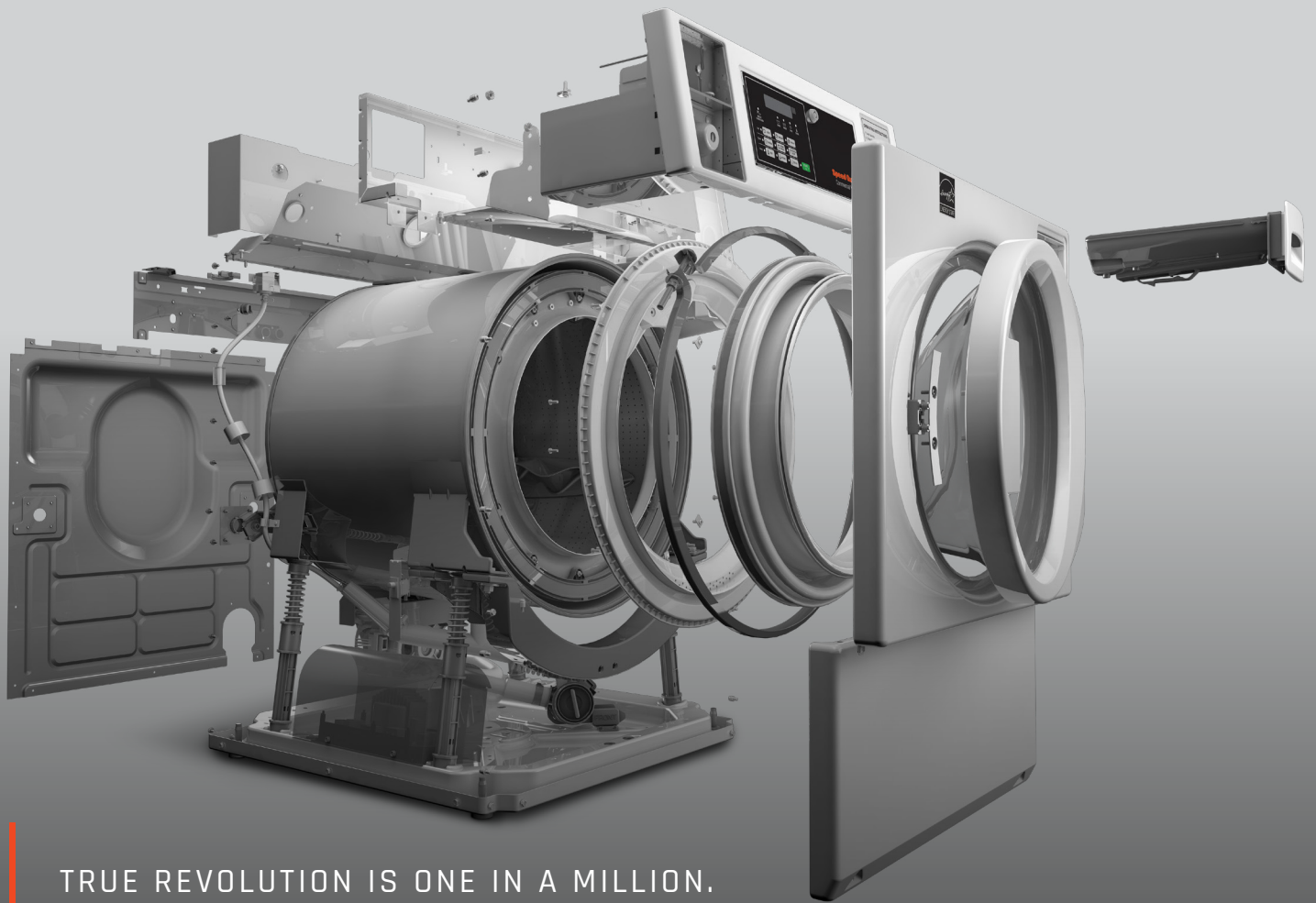



TRUE REVOLUTION IS ONE IN A MILLION.

Meet The One.

At Speed Queen®, we're constantly pushing the boundaries of what's possible in laundry equipment. Through our unique five-step product development process, including rigorous testing that guarantees superior industrial quality, we're introducing innovation and technology that are changing the way our customers think about laundry. And never has this dedication to advancing our industry manifested in anything more revolutionary than the Speed Queen® front load washer.

Engineered and built like no other, the Speed Queen® front load washer is designed to be everything people thought a washer couldn't be, beginning with its revolutionary new suspension and sensing technology. This groundbreaking innovation manages and redistributes any and all out-of-balance loads to deliver uninterrupted cycles, virtually eliminate vibration and operate so quietly neighboring residents won't even know it's running. It also touts an incredible 440 G-Force extraction speed to maximize moisture removal, reduce dry times and minimize utility costs. And as if that's not game-changing enough, this smooth-running, laundry-optimizing machine delivers increased water efficiency and a redesigned, 10-degree tilted control panel for easier readability and the ultimate user experience. It's everything you never knew it could be.

FRONT LOAD WASHERS

Everything You Ever Wanted.

Larger door opening

15.5" diameter and a 180° door swing help customers quickly load and unload the machine.

4-Compartment soap dispenser

Redesigned soap dispenser on Quantum® models offers compartments for pre-wash detergent, wash detergent, bleach and fabric softener.

Improved dispenser flushing

Four times more flushing and siphoning delivers superior cleaning of dispenser, reducing the need for ongoing maintenance and cleaning.

30% Larger coin box

Larger integrated coin box on front control machines reduces the time you spend collecting coins. Coin and card capable.

Heavy-duty design

Features like a rugged suspension system and stainless steel washtub and outer drain combine to deliver long-lasting performance.





And Everything You Never Knew it Could Be.



Revolutionary balancing technology

Speed Queen® front load washers introduce improved out-of-balance technology that uses a redesigned suspension and advanced sensing logic to manage and redistribute out-of-balance loads, delivering smooth, uninterrupted wash cycles every time.



2.5 Times less noise

Speed Queen's® solid design significantly reduces vibration and noise without sacrificing spin speed or cycle times, minimizing the negative effects your laundry has on neighboring residents.



Incredible 440 G-Force extraction

We increased our already industry-leading extraction speed to even further maximize moisture removal and minimize dry times, something your residents will appreciate as much as your bottom line.



Improved efficiency

Speed Queen® front load washers have 20 percent more capacity than previous models while only increasing water usage by six percent, delivering better efficiency overall while offering the same premium wash quality. The result is heightened customer satisfaction without a significant impact on utilities.



10° Tilted control panel

Speed Queen® front load washer control panels are angled ten degrees up toward the user's line of sight, allowing for easy readability without the need to bend down—a small change that makes a big impact on residents.



Patent-pending baffles

These revolutionary baffles feature a patent-pending design that lifts and cascades water throughout the entire load, delivering the absolute best quality wash.

Front Load Washer Specifications

	Front Load Washer	Front Load Washer
Available Controls	Gold	Gold, Coin Slide
Available Control Location	Front	Rear
Cylinder Volume - cu. ft. (liters)	3.42 (96.8)	3.42 (96.8)
Width - in (mm)	26.875 (683)	26.875 (683)
Depth - in (mm)	27.75 (704)	27.75 (704)
Height - in (mm)	44.375 (1126)	43.875 (1114)
Spin Speed G-Force (RPM)	440 (1200)	440 (1200)
Motor Size - HP (kw)	Variable Speed Induction 0.9 (0.67)	Variable Speed Induction 0.9 (0.67)
Water Consumption per Cycle - g (l)**	13.68 (51.8)	13.68 (51.8)
IWF (Water Factor)**	4.0	4.0
MEF ₂ (Modified Energy Factor)**	2.20	2.20
Available Water Temperatures	3	3
Available Cycles*	Normal, Perm Press, Delicate	Normal, Perm Press, Delicate
Water Pressure - PSI (Bar)	20-120 (1.4/8.3)	20-120 (1.4/8.3)
Cycle Indicator Lights	Yes	Yes
Cylinder Finish	Stainless Steel	Stainless Steel
Available Colors	White, Stainless	White
Door Type (Solid/Window)	Window	Window
Available Electrical Requirements (Voltage/Hz/Ph - Breaker Size)	120/60/1 - 15 Amp	120/60/1 - 15 Amp
Net Weight - lb (kg)	260 (118)	260 (118)
Shipping Weight - lb (kg)	270 (122.5)	270 (122.5)
Shipping Width - in (mm)	34 (864)	34 (864)
Shipping Depth - in (mm)	30 (762)	30 (762)
Shipping Height - in (mm)	44.5 (1130)	44.5 (1130)
Available Agency Approvals	cULus	cULus



All models shown with Quantum® controls

*Information provided applies to the premier control offered by product class.

**Average usage based on multiple load sizes and current DOE test protocol. Real usage will vary depending on load size, composition and cycle selectivity.

Learn more about Speed Queen® front load washers at speedqueencommercial.com/FLW.

